

RESOLUTION

WHEREAS, there is pending before this Honorable Board an amended bond act which incorporates, *inter alia*, Capital Project RMUS3 – Muscoot Farm Infrastructure and Capital Project RMUS7 – Muscoot Farm Site Work (the “Bond Act”); and

WHEREAS, this Honorable Board has determined that the proposed Bond Act would constitute an action under Article 8 of the Environmental Conservation Law, known as the New York State Environmental Quality Review Act (“SEQR”); and

WHEREAS, pursuant to SEQR and its implementing regulations (6 NYCRR Part 617), the Bond Act, as it relates to the aforementioned capital projects, is classified as a “Type I” action, which requires this Honorable Board to make a determination as to whether the proposed action will have a significant impact on the environment; and

WHEREAS, in accordance with SEQR, a notice of intent for the County of Westchester to serve as Lead Agency was distributed to all involved and interested agencies on May 25, 2022, and since no objections were received, your Honorable Board may assume the role of Lead Agency for the environmental review of these projects; and

WHEREAS, in accordance with SEQR and its implementing regulations, a Full Environmental Assessment Form has been prepared to assist this Honorable Board in its environmental assessment of this proposed action; and

WHEREAS, this Honorable Board has carefully considered the proposed action and has reviewed the attached Full Environmental Assessment Form and the criteria set forth in Section 617.7 of the implementing regulations and has identified the relevant areas of environmental concern, as described in the attached Short Environmental Assessment Form, to determine if this proposed action will have a significant impact on the environment.

NOW, THEREFORE, be it resolved by the County Board of Legislators of the County of Westchester, State of New York, as follows:

RESOLVED, that based upon the Honorable Board’s review of the Full Environmental Assessment Form and for the reasons set forth therein, this Board finds that there will be no significant adverse impact on the environment from the Bond Act and be it further

RESOLVED, that the Clerk of the Board of Legislators is authorized and directed to sign the “Determination of Significance” in the Full Environmental Assessment Form, which is attached hereto and made a part hereof, as the “Responsible Officer in Lead Agency”; to issue this “Negative Declaration” on behalf of this Board in satisfaction of SEQR and its implementing regulations; and to immediately transmit same to the Commissioner of Planning to be filed, published and made available pursuant to the requirements of Part 617 of 6 NYCRR; and be it further

RESOLVED, that the Resolution shall take effect immediately.

TO: Michelle Greenbaum, Senior Assistant County Attorney
Jeffrey Goldman, Senior Assistant County Attorney

FROM: David S. Kvinge, AICP, RLA, CFM
Assistant Commissioner



DATE: June 25, 2022

SUBJECT: **STATE ENVIRONMENTAL QUALITY REVIEW FOR CAPITAL PROJECTS
RMUS3 MUSCOOT FARM INFRASTRUCTURE
RMUS7 MUSCOOT FARM SITE WORK**

The Planning Department has reviewed the above referenced capital projects (Fact Sheets #1968 and #1970), in accordance with the State Environmental Quality Review Act and its implementing regulations, 6 NYCRR Part 617 (SEQR).

These two capital projects have been collectively classified as a Type I action pursuant to SEQR. As required for Type I actions, a Full Environmental Assessment Form was prepared for the project and coordinated review was initiated on behalf of the Board of Legislators.

In accordance with SEQR, a notice of intent for the County to serve as Lead Agency was distributed to involved and interested agencies on May 25, 2022. Since no objections were received, the Board of Legislators may assume the role of Lead Agency for the environmental review of these projects. Attached is the Full Environmental Assessment Form that has been prepared for these projects for consideration by the Board of Legislators.

Please contact me if you require any additional information regarding this document.

DSK/cnm

Att.

cc: Andrew Ferris, Chief of Staff
Paula Friedman, Assistant to the County Executive
Tami Altschiller, Assistant Chief Deputy County Attorney
Gideon Grande, Deputy Budget Director
Lorraine Marzola, Associate Budget Director
Kathleen O'Connor, Commissioner of Parks, Recreation and Conservation
Peter Tartaglia, First Deputy Commissioner, Dept. of Parks, Recreation and Conservation
Kelly Sheehan, Assistant Commissioner
William Brady, Chief Planner
Michael Lipkin, Associate Planner
Claudia Maxwell, Associate Environmental Planner

**Full Environmental Assessment Form
Part 1 - Project and Setting**

Instructions for Completing Part 1

Part 1 is to be completed by the applicant or project sponsor. Responses become part of the application for approval or funding, are subject to public review, and may be subject to further verification.

Complete Part 1 based on information currently available. If additional research or investigation would be needed to fully respond to any item, please answer as thoroughly as possible based on current information; indicate whether missing information does not exist, or is not reasonably available to the sponsor; and, when possible, generally describe work or studies which would be necessary to update or fully develop that information.

Applicants/sponsors must complete all items in Sections A & B. In Sections C, D & E, most items contain an initial question that must be answered either "Yes" or "No". If the answer to the initial question is "Yes", complete the sub-questions that follow. If the answer to the initial question is "No", proceed to the next question. Section F allows the project sponsor to identify and attach any additional information. Section G requires the name and signature of the applicant or project sponsor to verify that the information contained in Part 1 is accurate and complete.

A. Project and Applicant/Sponsor Information.

Name of Action or Project: Muscoot Farm Site and Infrastructure Improvements		
Project Location (describe, and attach a general location map): 51 Route 100, Katonah (Town of Somers), Westchester County, New York		
Brief Description of Proposed Action (include purpose or need): Various improvements are proposed to maintain and better manage this popular County park and active farm. Project will include in-kind replacement of brick sidewalks and patio's around the main house, gravel pathways, and replacement of the old woven wire pasture fences with wood and/or steel posts with woven wire mesh, along with removal of vegetation that has grown along the fence lines. The existing parking lot, which currently consists of compacted soil and gravel, will be reconstructed with porous pavement and landscaped islands. The driveway and maintenance yard, which also consists of compacted soil and gravel, will be paved instead in order to improve operations and minimize potential infiltration of any foreign matter associated with maintenance operations. A bioretention basin will be installed on the west side of the maintenance facility to capture and treat stormwater runoff from the new pavement. The project will also include construction of a new restroom building and installation of a new septic field to handle sanitary waste from the new facility, as well as from existing onsite facilities which will be rerouted to the new septic field. To alleviate wet conditions in the certain active areas of the farm, re-grading and drainage structures will be installed to collect excess storm water and direct it to a new basin that will be constructed north of the storage barn and carriage house, where an existing shed will be removed.		
Name of Applicant/Sponsor: County of Westchester	Telephone: 914-995-2000	E-Mail:
Address: 148 Martine Avenue		
City/PO: White Plains	State: New York	Zip Code: 10601
Project Contact (if not same as sponsor; give name and title/role): David S. Kvinge, Director of Environmental Planning	Telephone: 914-995-4400	E-Mail: dsk2@westchestergov.com
Address: 148 Martine Avenue, Room 432		
City/PO: White Plains	State: NY	Zip Code: 10601
Property Owner (if not same as sponsor):	Telephone:	E-Mail:
Address:		
City/PO:	State:	Zip Code:

B. Government Approvals

B. Government Approvals, Funding, or Sponsorship. ("Funding" includes grants, loans, tax relief, and any other forms of financial assistance.)		
Government Entity	If Yes: Identify Agency and Approval(s) Required	Application Date (Actual or projected)
a. City Counsel, Town Board, <input type="checkbox"/> Yes <input checked="" type="checkbox"/> No or Village Board of Trustees		
b. City, Town or Village <input type="checkbox"/> Yes <input checked="" type="checkbox"/> No Planning Board or Commission		
c. City, Town or <input type="checkbox"/> Yes <input checked="" type="checkbox"/> No Village Zoning Board of Appeals		
d. Other local agencies <input checked="" type="checkbox"/> Yes <input type="checkbox"/> No	NYCDEP Lease amendment	
e. County agencies <input checked="" type="checkbox"/> Yes <input type="checkbox"/> No	BOL funding DOH septic system	Anticipated Summer 2022 January 4, 2022
f. Regional agencies <input type="checkbox"/> Yes <input type="checkbox"/> No		
g. State agencies <input checked="" type="checkbox"/> Yes <input type="checkbox"/> No	NYSDEC SPDES SHPO	TBD December 3, 2022
h. Federal agencies <input type="checkbox"/> Yes <input type="checkbox"/> No		
i. Coastal Resources.		
i. Is the project site within a Coastal Area, or the waterfront area of a Designated Inland Waterway?		<input type="checkbox"/> Yes <input checked="" type="checkbox"/> No
ii. Is the project site located in a community with an approved Local Waterfront Revitalization Program?		<input type="checkbox"/> Yes <input checked="" type="checkbox"/> No
iii. Is the project site within a Coastal Erosion Hazard Area?		<input type="checkbox"/> Yes <input type="checkbox"/> No

C. Planning and Zoning

C.1. Planning and zoning actions.	
Will administrative or legislative adoption, or amendment of a plan, local law, ordinance, rule or regulation be the only approval(s) which must be granted to enable the proposed action to proceed?	<input type="checkbox"/> Yes <input checked="" type="checkbox"/> No
<ul style="list-style-type: none"> • If Yes, complete sections C, F and G. • If No, proceed to question C.2 and complete all remaining sections and questions in Part 1 	
C.2. Adopted land use plans.	
a. Do any municipally- adopted (city, town, village or county) comprehensive land use plan(s) include the site where the proposed action would be located?	<input checked="" type="checkbox"/> Yes <input type="checkbox"/> No
If Yes, does the comprehensive plan include specific recommendations for the site where the proposed action would be located?	<input type="checkbox"/> Yes <input checked="" type="checkbox"/> No
b. Is the site of the proposed action within any local or regional special planning district (for example: Greenway: Brownfield Opportunity Area (BOA); designated State or Federal heritage area; watershed management plan; or other?)	<input checked="" type="checkbox"/> Yes <input type="checkbox"/> No
If Yes, identify the plan(s): NYC Watershed Boundary	

c. Is the proposed action located wholly or partially within an area listed in an adopted municipal open space plan, or an adopted municipal farmland protection plan?	<input type="checkbox"/> Yes <input checked="" type="checkbox"/> No
If Yes, identify the plan(s):	

C.3. Zoning

a. Is the site of the proposed action located in a municipality with an adopted zoning law or ordinance. Yes No
If Yes, what is the zoning classification(s) including any applicable overlay district?

R120 Residence District

b. Is the use permitted or allowed by a special or conditional use permit? Yes No

c. Is a zoning change requested as part of the proposed action? Yes No
If Yes,

i. What is the proposed new zoning for the site? _____

C.4. Existing community services.

a. In what school district is the project site located? Somers School District

b. What police or other public protection forces serve the project site?
NYS Police & Somers Police Department

c. Which fire protection and emergency medical services serve the project site?
Somers Fire District & Somers EMS

d. What parks serve the project site?
N/A. The site is a county park.

D. Project Details

D.1. Proposed and Potential Development

a. What is the general nature of the proposed action (e.g., residential, industrial, commercial, recreational; if mixed, include all components)? Recreational

b. a. Total acreage of the site of the proposed action? 30.6 acres
b. Total acreage to be physically disturbed? 4.5 acres
c. Total acreage (project site and any contiguous properties) owned or controlled by the applicant or project sponsor? 777 acres

c. Is the proposed action an expansion of an existing project or use? Yes No
i. If Yes, what is the approximate percentage of the proposed expansion and identify the units (e.g., acres, miles, housing units, square feet)? % N/A Units: _____

d. Is the proposed action a subdivision, or does it include a subdivision? Yes No
If Yes,
i. Purpose or type of subdivision? (e.g., residential, industrial, commercial; if mixed, specify types)

ii. Is a cluster/conservation layout proposed? Yes No

iii. Number of lots proposed? _____
iv. Minimum and maximum proposed lot sizes? Minimum _____ Maximum _____

e. Will the proposed action be constructed in multiple phases? Yes No
i. If No, anticipated period of construction: 12 months

ii. If Yes:
• Total number of phases anticipated _____
• Anticipated commencement date of phase 1 (including demolition) _____ month _____ year
• Anticipated completion date of final phase _____ month _____ year
• Generally describe connections or relationships among phases, including any contingencies where progress of one phase may determine timing or duration of future phases: _____

f. Does the project include new residential uses? Yes No
 If Yes, show numbers of units proposed.

	<u>One Family</u>	<u>Two Family</u>	<u>Three Family</u>	<u>Multiple Family (four or more)</u>
Initial Phase	_____	_____	_____	_____
At completion of all phases	_____	_____	_____	_____

g. Does the proposed action include new non-residential construction (including expansions)? Yes No
 If Yes,

i. Total number of structures 1 (New restroom building)

ii. Dimensions (in feet) of largest proposed structure: 17' height; 28' width; and 30' length

iii. Approximate extent of building space to be heated or cooled: 840 square feet

h. Does the proposed action include construction or other activities that will result in the impoundment of any liquids, such as creation of a water supply, reservoir, pond, lake, waste lagoon or other storage? Yes No
 If Yes,

i. Purpose of the impoundment: Storm water management

ii. If a water impoundment, the principal source of the water: Ground water Surface water streams Other specify: Stormwater runoff.

iii. If other than water, identify the type of impounded/contained liquids and their source. _____

iv. Approximate size of the proposed impoundment. Volume: _____ million gallons; surface area: 7,720 SF acres

v. Dimensions of the proposed dam or impounding structure: 5' height; 125' length

vi. Construction method/materials for the proposed dam or impounding structure (e.g., earth fill, rock, wood, concrete): Impoundment will be created by excavation. 4" of topsoil will be installed on the surface.

D.2. Project Operations

a. Does the proposed action include any excavation, mining, or dredging, during construction, operations, or both? Yes No
 (Not including general site preparation, grading or installation of utilities or foundations where all excavated materials will remain onsite)

If Yes:

i. What is the purpose of the excavation or dredging? Excavation to reconstruct existing facilities and install new facilities.

ii. How much material (including rock, earth, sediments, etc.) is proposed to be removed from the site?

- Volume (specify tons or cubic yards): 3,735 CY
- Over what duration of time? 12 Months

iii. Describe nature and characteristics of materials to be excavated or dredged, and plans to use, manage or dispose of them. Soils range from sandy/gravelly soils in the pathways and parking lot to rich loamy soils in the existing pastures. Some contaminated soils are expected due to its use as a farm for more than one hundred years. Any contaminated soils will remain on site for re-use elsewhere within the property.

iv. Will there be onsite dewatering or processing of excavated materials? Yes No
 If yes, describe. Soil stockpiles will be used to facilitate separation and segregation of contaminated soils from clean soils.
No dewatering.

v. What is the total area to be dredged or excavated? _____ 1.2 acres

vi. What is the maximum area to be worked at any one time? _____ 1.2 acres

vii. What would be the maximum depth of excavation or dredging? _____ 6' feet

viii. Will the excavation require blasting? Yes No

ix. Summarize site reclamation goals and plan: _____
Excavated soils intended to remain on site will be re-purposed where appropriate as either backfill material for proposed structures, top dressing and re-seeding of existing pastures or spread over existing dirt roads to eliminate ponding and facilitate positive drainage. All other areas of excavation will be restored to their original condition.

b. Would the proposed action cause or result in alteration of, increase or decrease in size of, or encroachment into any existing wetland, waterbody, shoreline, beach or adjacent area? Yes No
 If Yes:

i. Identify the wetland or waterbody which would be affected (by name, water index number, wetland map number or geographic description): _____

ii. Describe how the proposed action would affect that waterbody or wetland, e.g. excavation, fill, placement of structures, or alteration of channels, banks and shorelines. Indicate extent of activities, alterations and additions in square feet or acres:

iii. Will the proposed action cause or result in disturbance to bottom sediments? Yes No
If Yes, describe: _____

iv. Will the proposed action cause or result in the destruction or removal of aquatic vegetation? Yes No
If Yes:

- acres of aquatic vegetation proposed to be removed: _____
- expected acreage of aquatic vegetation remaining after project completion: _____
- purpose of proposed removal (e.g. beach clearing, invasive species control, boat access): _____
- proposed method of plant removal: _____
- if chemical/herbicide treatment will be used, specify product(s): _____

v. Describe any proposed reclamation/mitigation following disturbance: _____

c. Will the proposed action use, or create a new demand for water? Yes No

If Yes:

i. Total anticipated water usage/demand per day: _____ gallons/day

ii. Will the proposed action obtain water from an existing public water supply? Yes No

If Yes:

- Name of district or service area: _____
- Does the existing public water supply have capacity to serve the proposal? Yes No
- Is the project site in the existing district? Yes No
- Is expansion of the district needed? Yes No
- Do existing lines serve the project site? Yes No

iii. Will line extension within an existing district be necessary to supply the project? Yes No

If Yes:

- Describe extensions or capacity expansions proposed to serve this project: _____
- Source(s) of supply for the district: _____

iv. Is a new water supply district or service area proposed to be formed to serve the project site? Yes No

If Yes:

- Applicant/sponsor for new district: _____
- Date application submitted or anticipated: _____
- Proposed source(s) of supply for new district: _____

v. If a public water supply will not be used, describe plans to provide water supply for the project: _____

vi. If water supply will be from wells (public or private), what is the maximum pumping capacity: _____ gallons/minute.

d. Will the proposed action generate liquid wastes? Yes No

If Yes:

i. Total anticipated liquid waste generation per day: 5,000 gallons/day

ii. Nature of liquid wastes to be generated (e.g., sanitary wastewater, industrial; if combination, describe all components and approximate volumes or proportions of each): _____

Sanitary wastewater

iii. Will the proposed action use any existing public wastewater treatment facilities? Yes No

If Yes:

- Name of wastewater treatment plant to be used: _____
- Name of district: _____
- Does the existing wastewater treatment plant have capacity to serve the project? Yes No
- Is the project site in the existing district? Yes No
- Is expansion of the district needed? Yes No

- Do existing sewer lines serve the project site? Yes No
 - Will a line extension within an existing district be necessary to serve the project? Yes No
- If Yes:
- Describe extensions or capacity expansions proposed to serve this project: _____

- iv. Will a new wastewater (sewage) treatment district be formed to serve the project site? Yes No
- If Yes:
- Applicant/sponsor for new district: _____
 - Date application submitted or anticipated: _____
 - What is the receiving water for the wastewater discharge? _____

v. If public facilities will not be used, describe plans to provide wastewater treatment for the project, including specifying proposed receiving water (name and classification if surface discharge or describe subsurface disposal plans):

A new restroom building will be constructed along with a new onsite septic system to replace the existing antiquated septic system and meet current demand. Sanitary wastewater from the existing main house and bathrooms adjacent to the activity building will be redirected to the new septic system.

vi. Describe any plans or designs to capture, recycle or reuse liquid waste: _____

N/A _____

- e. Will the proposed action disturb more than one acre and create stormwater runoff, either from new point sources (i.e. ditches, pipes, swales, curbs, gutters or other concentrated flows of stormwater) or non-point source (i.e. sheet flow) during construction or post construction? Yes No

- If Yes:
- i. How much impervious surface will the project create in relation to total size of project parcel?
- _____ Square feet or 0.27 acres (impervious surface)
- _____ Square feet or 777 acres (parcel size)
- ii. Describe types of new point sources. Point sources will be limited to overflow outfalls for the maintenance area bioretention basin, the farm area stormwater collection basin, and parking lot infiltration trench.

iii. Where will the stormwater runoff be directed (i.e. on-site stormwater management facility/structures, adjacent properties, groundwater, on-site surface water or off-site surface waters)?

Overflow outfall from maintenance area bioretention basin will be directed to a depression beside Route 100. Overflow from farm area basin will be directed NYCDEP owned land to the west as will any overflow from an infiltration trench to be constructed on the west side of the porous pavement parking lot.

- If to surface waters, identify receiving water bodies or wetlands: _____
- Overflow from farm area basin will discharge into a drainage channel on NYCDEP land which leads to the New Croton Reservoir.

- Will stormwater runoff flow to adjacent properties? Yes No

iv. Does the proposed plan minimize impervious surfaces, use pervious materials or collect and re-use stormwater? Yes No

f. Does the proposed action include, or will it use on-site, one or more sources of air emissions, including fuel combustion, waste incineration, or other processes or operations? Yes No

Project will not add any new sources below.

- If Yes, identify:
- i. Mobile sources during project operations (e.g., heavy equipment, fleet or delivery vehicles)
- _____
- ii. Stationary sources during construction (e.g., power generation, structural heating, batch plant, crushers)
- _____
- iii. Stationary sources during operations (e.g., process emissions, large boilers, electric generation)
- _____

g. Will any air emission sources named in D.2.f (above), require a NY State Air Registration, Air Facility Permit, or Federal Clean Air Act Title IV or Title V Permit? Yes No

If Yes:

i. Is the project site located in an Air quality non-attainment area? (Area routinely or periodically fails to meet ambient air quality standards for all or some parts of the year) Yes No

- ii. In addition to emissions as calculated in the application, the project will generate:
- _____ Tons/year (short tons) of Carbon Dioxide (CO₂)
 - _____ Tons/year (short tons) of Nitrous Oxide (N₂O)
 - _____ Tons/year (short tons) of Perfluorocarbons (PFCs)
 - _____ Tons/year (short tons) of Sulfur Hexafluoride (SF₆)
 - _____ Tons/year (short tons) of Carbon Dioxide equivalent of Hydrofluorocarbons (HFCs)
 - _____ Tons/year (short tons) of Hazardous Air Pollutants (HAPs)

h. Will the proposed action generate or emit methane (including, but not limited to, sewage treatment plants, landfills, composting facilities)? Yes No

If Yes:

i. Estimate methane generation in tons/year (metric): _____

ii. Describe any methane capture, control or elimination measures included in project design (e.g., combustion to generate heat or electricity, flaring): _____

i. Will the proposed action result in the release of air pollutants from open-air operations or processes, such as quarry or landfill operations? Yes No

If Yes: Describe operations and nature of emissions (e.g., diesel exhaust, rock particulates/dust): _____

j. Will the proposed action result in a substantial increase in traffic above present levels or generate substantial new demand for transportation facilities or services? Yes No

If Yes:

i. When is the peak traffic expected (Check all that apply): Morning Evening Weekend
 Randomly between hours of _____ to _____.

ii. For commercial activities only, projected number of truck trips/day and type (e.g., semi trailers and dump trucks): _____

iii. Parking spaces: Existing _____ Proposed _____ Net increase/decrease _____

iv. Does the proposed action include any shared use parking? Yes No

v. If the proposed action includes any modification of existing roads, creation of new roads or change in existing access, describe: _____

vi. Are public/private transportation service(s) or facilities available within 1/2 mile of the proposed site? Yes No

vii. Will the proposed action include access to public transportation or accommodations for use of hybrid, electric or other alternative fueled vehicles? Yes No

viii. Will the proposed action include plans for pedestrian or bicycle accommodations for connections to existing pedestrian or bicycle routes? Yes No

k. Will the proposed action (for commercial or industrial projects only) generate new or additional demand for energy? Yes No

If Yes:

i. Estimate annual electricity demand during operation of the proposed action: _____

ii. Anticipated sources/suppliers of electricity for the project (e.g., on-site combustion, on-site renewable, via grid/local utility, or other): _____

iii. Will the proposed action require a new, or an upgrade, to an existing substation? Yes No

l. Hours of operation. Answer all items which apply.

<p>i. During Construction:</p> <ul style="list-style-type: none"> • Monday - Friday: _____ 7:00am to 5:00pm • Saturday: _____ 7:00am to 5:00pm as needed • Sunday: _____ • Holidays: _____ 	<p>ii. During Operations: Existing ongoing active farm.</p> <ul style="list-style-type: none"> • Monday - Friday: _____ • Saturday: _____ • Sunday: _____ • Holidays: _____
--	---

m. Will the proposed action produce noise that will exceed existing ambient noise levels during construction, operation, or both? Yes No
 If yes:
 i. Provide details including sources, time of day and duration:

ii. Will the proposed action remove existing natural barriers that could act as a noise barrier or screen? Yes No
 Describe: _____

n. Will the proposed action have outdoor lighting? Yes No
 If yes:
 i. Describe source(s), location(s), height of fixture(s), direction/aim, and proximity to nearest occupied structures:

ii. Will proposed action remove existing natural barriers that could act as a light barrier or screen? Yes No
 Describe: _____

o. Does the proposed action have the potential to produce odors for more than one hour per day? Yes No
 If Yes, describe possible sources, potential frequency and duration of odor emissions, and proximity to nearest occupied structures:

p. Will the proposed action include any bulk storage of petroleum (combined capacity of over 1,100 gallons) or chemical products 185 gallons in above ground storage or any amount in underground storage? Yes No
 If Yes:
 i. Product(s) to be stored _____
 ii. Volume(s) _____ per unit time _____ (e.g., month, year)
 iii. Generally, describe the proposed storage facilities: _____

q. Will the proposed action (commercial, industrial and recreational projects only) use pesticides (i.e., herbicides, insecticides) during construction or operation? Yes No
 If Yes:
 i. Describe proposed treatment(s):
 No use of pesticides during construction. Farm operations will remain the same.

ii. Will the proposed action use Integrated Pest Management Practices? Yes No

r. Will the proposed action (commercial or industrial projects only) involve or require the management or disposal of solid waste (excluding hazardous materials)? Yes No
 If Yes:
 i. Describe any solid waste(s) to be generated during construction or operation of the facility:
 • Construction: _____ 40 CY tons per _____ 12 month period (unit of time)
 • Operation : _____ No change (N/C). tons per _____ (unit of time)
 ii. Describe any proposals for on-site minimization, recycling or reuse of materials to avoid disposal as solid waste:
 • Construction: _____
 • Operation: _____ N/C
 iii. Proposed disposal methods/facilities for solid waste generated on-site:
 • Construction: There will be 10,000 LF of Woven Wire Fence being removed. While the the fence fabric becomes the property of the Contractor to be disposed of off-site, it will likely be recycled at a NYSDEC approved metal recycling facility.
 • Operation: _____ N/C

s. Does the proposed action include construction or modification of a solid waste management facility? Yes No
 If Yes:
 i. Type of management or handling of waste proposed for the site (e.g., recycling or transfer station, composting, landfill, or other disposal activities): _____
 ii. Anticipated rate of disposal/processing:
 • _____ Tons/month, if transfer or other non-combustion/thermal treatment, or
 • _____ Tons/hour, if combustion or thermal treatment
 iii. If landfill, anticipated site life: _____ years

t. Will the proposed action at the site involve the commercial generation, treatment, storage, or disposal of hazardous waste? Yes No
 If Yes:
 i. Name(s) of all hazardous wastes or constituents to be generated, handled or managed at facility: _____

 ii. Generally describe processes or activities involving hazardous wastes or constituents: _____

 iii. Specify amount to be handled or generated _____ tons/month
 iv. Describe any proposals for on-site minimization, recycling or reuse of hazardous constituents: _____

 v. Will any hazardous wastes be disposed at an existing offsite hazardous waste facility? Yes No
 If Yes: provide name and location of facility: _____

 If No: describe proposed management of any hazardous wastes which will not be sent to a hazardous waste facility:

E. Site and Setting of Proposed Action

E.1. Land uses on and surrounding the project site

a. Existing land uses.
 i. Check all uses that occur on, adjoining and near the project site.
 Urban Industrial Commercial Residential (suburban) Rural (non-farm)
 Forest Agriculture Aquatic Other (specify): _____
 ii. If mix of uses, generally describe:

b. Land uses and covertypes on the project site.

Land use or Covertype	Current Acreage	Acreage After Project Completion	Change (Acres +/-)
• Roads, buildings, and other paved or impervious surfaces	0.93	2.18	+1.25
• Forested	1.56	1.56	0.00
• Meadows, grasslands or brushlands (non-agricultural, including abandoned agricultural)	4.20	4.53	+0.33
• Agricultural (includes active orchards, field, greenhouse etc.)	20.89	20.56	-0.33
• Surface water features (lakes, ponds, streams, rivers, etc.)	0.02	0.00	-0.02
• Wetlands (freshwater or tidal)	0.00	0.00	0.00
• Non-vegetated (bare rock, earth or fill)	0.40	0.40	0.00
• Other Describe: <u>Gravel/Dirt Roads, Pathways and Parking Lots</u>	2.66	1.43	-1.23

c. Is the project site presently used by members of the community for public recreation? Yes No
i. If Yes: explain: The facility is a County park open to the public with public programs offered year-round.

d. Are there any facilities serving children, the elderly, people with disabilities (e.g., schools, hospitals, licensed day care centers, or group homes) within 1500 feet of the project site? Yes No
If Yes,
i. Identify Facilities:

e. Does the project site contain an existing dam? Yes No
If Yes:
i. Dimensions of the dam and impoundment:
• Dam height: _____ feet
• Dam length: _____ feet
• Surface area: _____ acres
• Volume impounded: _____ gallons OR acre-feet
ii. Dam's existing hazard classification: _____
iii. Provide date and summarize results of last inspection:

f. Has the project site ever been used as a municipal, commercial or industrial solid waste management facility, or does the project site adjoin property which is now, or was at one time, used as a solid waste management facility? Yes No
If Yes:
i. Has the facility been formally closed? Yes No
• If yes, cite sources/documentation: _____
ii. Describe the location of the project site relative to the boundaries of the solid waste management facility:

iii. Describe any development constraints due to the prior solid waste activities: _____

g. Have hazardous wastes been generated, treated and/or disposed of at the site, or does the project site adjoin property which is now or was at one time used to commercially treat, store and/or dispose of hazardous waste? Yes No
If Yes:
i. Describe waste(s) handled and waste management activities, including approximate time when activities occurred:

h. Potential contamination history. Has there been a reported spill at the proposed project site, or have any remedial actions been conducted at or adjacent to the proposed site? Yes No
If Yes:
i. Is any portion of the site listed on the NYSDEC Spills Incidents database or Environmental Site Remediation database? Check all that apply: Yes No
 Yes – Spills Incidents database Provide DEC ID number(s): _____
 Yes – Environmental Site Remediation database Provide DEC ID number(s): _____
 Neither database
ii. If site has been subject of RCRA corrective activities, describe control measures: _____
iii. Is the project within 2000 feet of any site in the NYSDEC Environmental Site Remediation database? Yes No
If yes, provide DEC ID number(s): _____
iv. If yes to (i), (ii) or (iii) above, describe current status of site(s): _____

v. Is the project site subject to an institutional control limiting property uses? Yes No

- If yes, DEC site ID number: _____
- Describe the type of institutional control (e.g., deed restriction or easement): _____
- Describe any use limitations: _____
- Describe any engineering controls: _____
- Will the project affect the institutional or engineering controls in place? Yes No
- Explain: _____

E.2. Natural Resources On or Near Project Site

a. What is the average depth to bedrock on the project site? _____ >6 feet

b. Are there bedrock outcroppings on the project site? Yes No
 If Yes, what proportion of the site is comprised of bedrock outcroppings? _____ 1.3 %

c. Predominant soil type(s) present on project site:

Chatfield-Charlton complex (CsD)	_____	38 %
Hinckley (HnB)	_____	25 %
Charlton-Chatfield complex (CrC)	_____	24 %

d. What is the average depth to the water table on the project site? Average: _____ >6 feet

e. Drainage status of project site soils:

<input checked="" type="checkbox"/> Well Drained:	_____	+/-94 % of site
<input checked="" type="checkbox"/> Moderately Well Drained:	_____	+/-5 % of site
<input checked="" type="checkbox"/> Poorly Drained	_____	<1 % of site

f. Approximate proportion of proposed action site with slopes:

<input type="checkbox"/> 0-10%:	_____	30 % of site
<input type="checkbox"/> 10-15%:	_____	10 % of site
<input type="checkbox"/> 15% or greater:	_____	60 % of site

g. Are there any unique geologic features on the project site? Yes No
 If Yes, describe: _____

h. Surface water features.

i. Does any portion of the project site contain wetlands or other waterbodies (including streams, rivers, ponds or lakes)? Yes No

ii. Do any wetlands or other waterbodies adjoin the project site? Yes No
 If Yes to either i or ii, continue. If No, skip to E.2.i.

iii. Are any of the wetlands or waterbodies within or adjoining the project site regulated by any federal, state or local agency? Yes No

iv. For each identified regulated wetland and waterbody on the project site, provide the following information:

- Streams: Name _____ Classification _____
- Lakes or Ponds: Name _____ Classification _____
- Wetlands: Name _____ Approximate Size _____
- Wetland No. (if regulated by DEC) _____

v. Are any of the above water bodies listed in the most recent compilation of NYS water quality-impaired waterbodies? Yes No
 If yes, name of impaired water body/bodies and basis for listing as impaired: _____

i. Is the project site in a designated Floodway? Yes No

j. Is the project site in the 100-year Floodplain? Yes No

k. Is the project site in the 500-year Floodplain? Yes No

l. Is the project site located over, or immediately adjoining, a primary, principal or sole source aquifer? Yes No
 If Yes:
 i. Name of aquifer: _____

m. Identify the predominant wildlife species that occupy or use the project site:
 Limited wildlife within active farm areas. deer, woodchuck, rabbit, mice.
 Bordering non-farm areas support typical Various birds, including Robin, Bluebird,
 woodland and edge species, such as wrens, warblers, woodpeckers, turkey.

n. Does the project site contain a designated significant natural community? Yes No
 If Yes:
 i. Describe the habitat/community (composition, function, and basis for designation): _____
 ii. Source(s) of description or evaluation: _____
 iii. Extent of community/habitat:
 • Currently: _____ acres
 • Following completion of project as proposed: _____ acres
 • Gain or loss (indicate + or -): _____ acres

o. Does project site contain any species of plant or animal that is listed by the federal government or NYS as endangered or threatened, or does it contain any areas identified as habitat for an endangered or threatened species? Yes No
 If Yes:
 i. Species and listing (endangered or threatened): _____

p. Does the project site contain any species of plant or animal that is listed by NYS as rare, or as a species of special concern? Yes No
 If Yes:
 i. Species and listing: _____

q. Is the project site or adjoining area currently used for hunting, trapping, fishing or shell fishing? Yes No
 If yes, give a brief description of how the proposed action may affect that use: _____

E.3. Designated Public Resources On or Near Project Site

a. Is the project site, or any portion of it, located in a designated agricultural district certified pursuant to Agriculture and Markets Law, Article 25-AA, Section 303 and 304? Yes No
 If Yes, provide county plus district name/number: WEST001

b. Are agricultural lands consisting of highly productive soils present? Yes No
 i. If Yes: acreage(s) on project site? Sutton (SuB) +/-2 acres; Hinckley (HnB) +/- 8 acres (within project boundaries)
 ii. Source(s) of soil rating(s): USDA Natural Resources Conservation Service

c. Does the project site contain all or part of, or is it substantially contiguous to, a registered National Natural Landmark? Yes No
 If Yes:
 i. Nature of the natural landmark: Biological Community Geological Feature
 ii. Provide brief description of landmark, including values behind designation and approximate size/extent: _____

d. Is the project site located in or does it adjoin a state listed Critical Environmental Area? Yes No
 If Yes:
 i. CEA name: County & State Park Lands
 ii. Basis for designation: Exceptional or unique character
 iii. Designating agency and date: Agency: Westchester County, Date: 1-31-90

e. Does the project site contain, or is it substantially contiguous to, a building, archaeological site, or district which is listed on the National or State Register of Historic Places, or that has been determined by the Commissioner of the NYS Office of Parks, Recreation and Historic Preservation to be eligible for listing on the State Register of Historic Places? Yes No

If Yes:

i. Nature of historic/archaeological resource: Archaeological Site Historic Building or District

ii. Name: Muscoot Farm

iii. Brief description of attributes on which listing is based:
Eligible for listing based on its contribution to broad patterns in our history and embodiment of the distinctive building characteristics of the period.

f. Is the project site, or any portion of it, located in or adjacent to an area designated as sensitive for archaeological sites on the NY State Historic Preservation Office (SHPO) archaeological site inventory? Yes No

g. Have additional archaeological or historic site(s) or resources been identified on the project site? Yes No

If Yes:

i. Describe possible resource(s): No additional historic or archaeological resources were identified in studies that were conducted for this property.

ii. Basis for identification: Phase 1A (Hartgen Archeological Associates, Inc., 2007); Phase 1B (Stony Creek Archaeology, Inc. 2021)

h. Is the project site within five miles of any officially designated and publicly accessible federal, state, or local scenic or aesthetic resource? Yes No

If Yes:

i. Identify resource: _____

ii. Nature of, or basis for, designation (e.g., established highway overlook, state or local park, state historic trail or scenic byway, etc.): _____

iii. Distance between project and resource: _____ miles.

i. Is the project site located within a designated river corridor under the Wild, Scenic and Recreational Rivers Program 6 NYCRR 666? Yes No

If Yes:

i. Identify the name of the river and its designation: _____

ii. Is the activity consistent with development restrictions contained in 6NYCRR Part 666? Yes No

F. Additional Information

Attach any additional information which may be needed to clarify your project.

If you have identified any adverse impacts which could be associated with your proposal, please describe those impacts plus any measures which you propose to avoid or minimize them.

G. Verification

I certify that the information provided is true to the best of my knowledge.

Applicant/Sponsor Name County of Westchester Date June 23, 2022

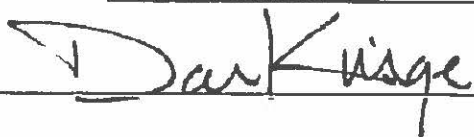
Signature  Title Assistant Commissioner



Disclaimer: The EAF Mapper is a screening tool intended to assist project sponsors and reviewing agencies in preparing an environmental assessment form (EAF). Not all questions asked in the EAF are answered by the EAF Mapper. Additional information on any EAF question can be obtained by consulting the EAF Workbooks. Although the EAF Mapper provides the most up-to-date digital data available to DEC, you may also need to contact local or other data sources in order to obtain data not provided by the Mapper. Digital data is not a substitute for agency determinations.

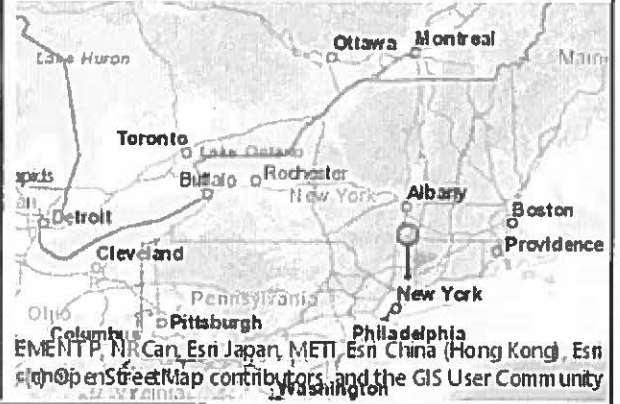

B.i.i [Coastal or Waterfront Area]	No
B.i.ii [Local Waterfront Revitalization Area]	No
C.2.b. [Special Planning District]	Yes - Digital mapping data are not available for all Special Planning Districts. Refer to EAF Workbook.
C.2.b. [Special Planning District - Name]	NYC Watershed Boundary
E.1.h [DEC Spills or Remediation Site - Potential Contamination History]	Digital mapping data are not available or are incomplete. Refer to EAF Workbook.
E.1.h.i [DEC Spills or Remediation Site - Listed]	Digital mapping data are not available or are incomplete. Refer to EAF Workbook.
E.1.h.i [DEC Spills or Remediation Site - Environmental Site Remediation Database]	Digital mapping data are not available or are incomplete. Refer to EAF Workbook.
E.1.h.iii [Within 2,000' of DEC Remediation Site]	No
E.2.g [Unique Geologic Features]	No
E.2.h.i [Surface Water Features]	No
E.2.h.ii [Surface Water Features]	Yes
E.2.h.iii [Surface Water Features]	Yes - Digital mapping information on local and federal wetlands and waterbodies is known to be incomplete. Refer to EAF Workbook.
E.2.h.v [Impaired Water Bodies]	No
E.2.i. [Floodway]	No
E.2.j. [100 Year Floodplain]	No
E.2.k. [500 Year Floodplain]	No
E.2.l. [Aquifers]	No
E.2.n. [Natural Communities]	No
E.2.o. [Endangered or Threatened Species]	No

E.2.p. [Rare Plants or Animals]	No
E.3.a. [Agricultural District]	Yes
E.3.a. [Agricultural District]	WEST001
E.3.c. [National Natural Landmark]	No
E.3.d [Critical Environmental Area]	Yes
E.3.d [Critical Environmental Area - Name]	County & State Park Lands
E.3.d.ii [Critical Environmental Area - Reason]	Exceptional or unique character
E.3.d.iii [Critical Environmental Area – Date and Agency]	Agency:Westchester County, Date:1-31-90
E.3.e. [National or State Register of Historic Places or State Eligible Sites]	Digital mapping data are not available or are incomplete. Refer to EAF Workbook.
E.3.f. [Archeological Sites]	Yes
E.3.i. [Designated River Corridor]	No

WESTCHESTER COUNTY, NEW YORK

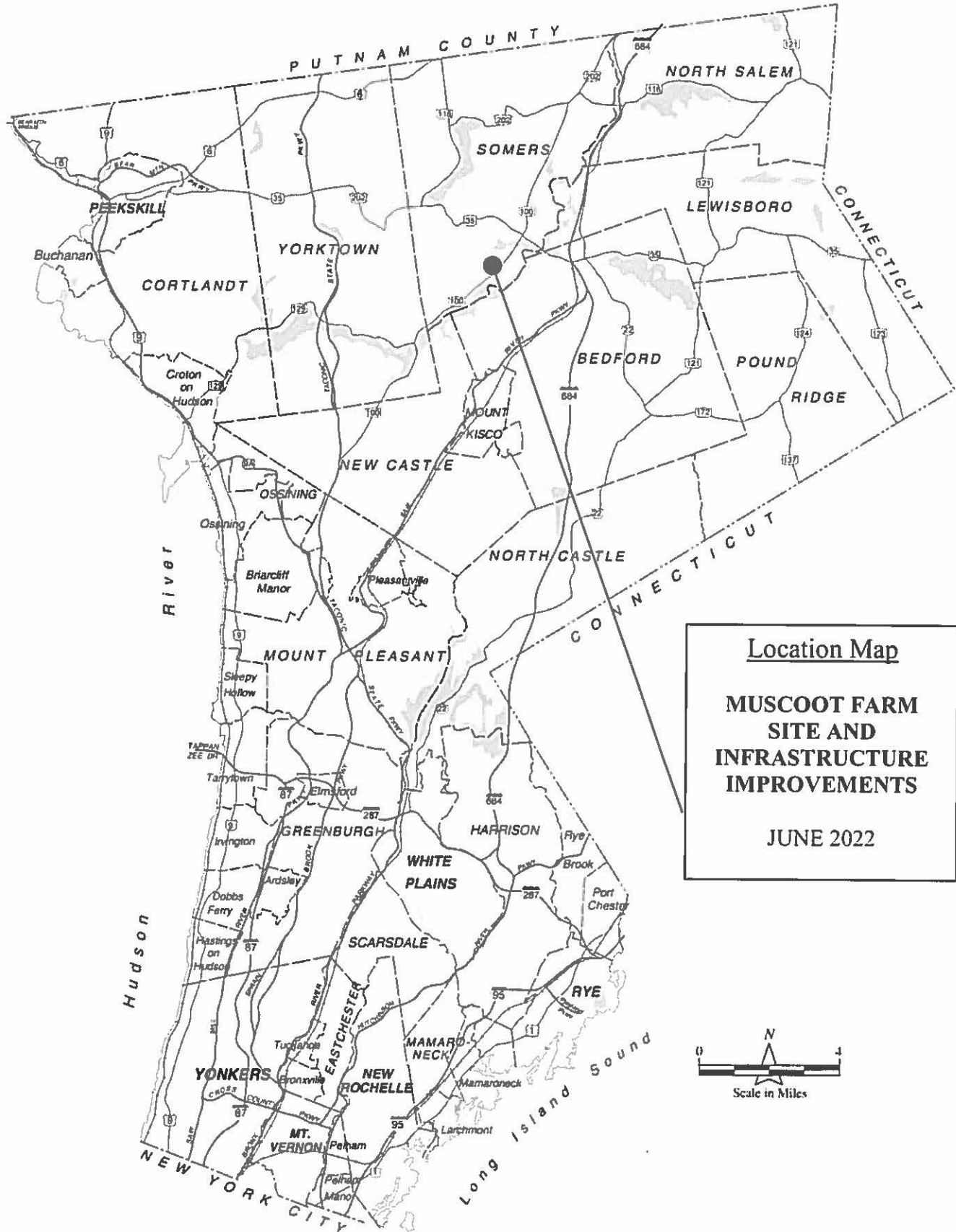

Location Map
**MUSCOOT FARM
SITE AND
INFRASTRUCTURE
IMPROVEMENTS**
JUNE 2022



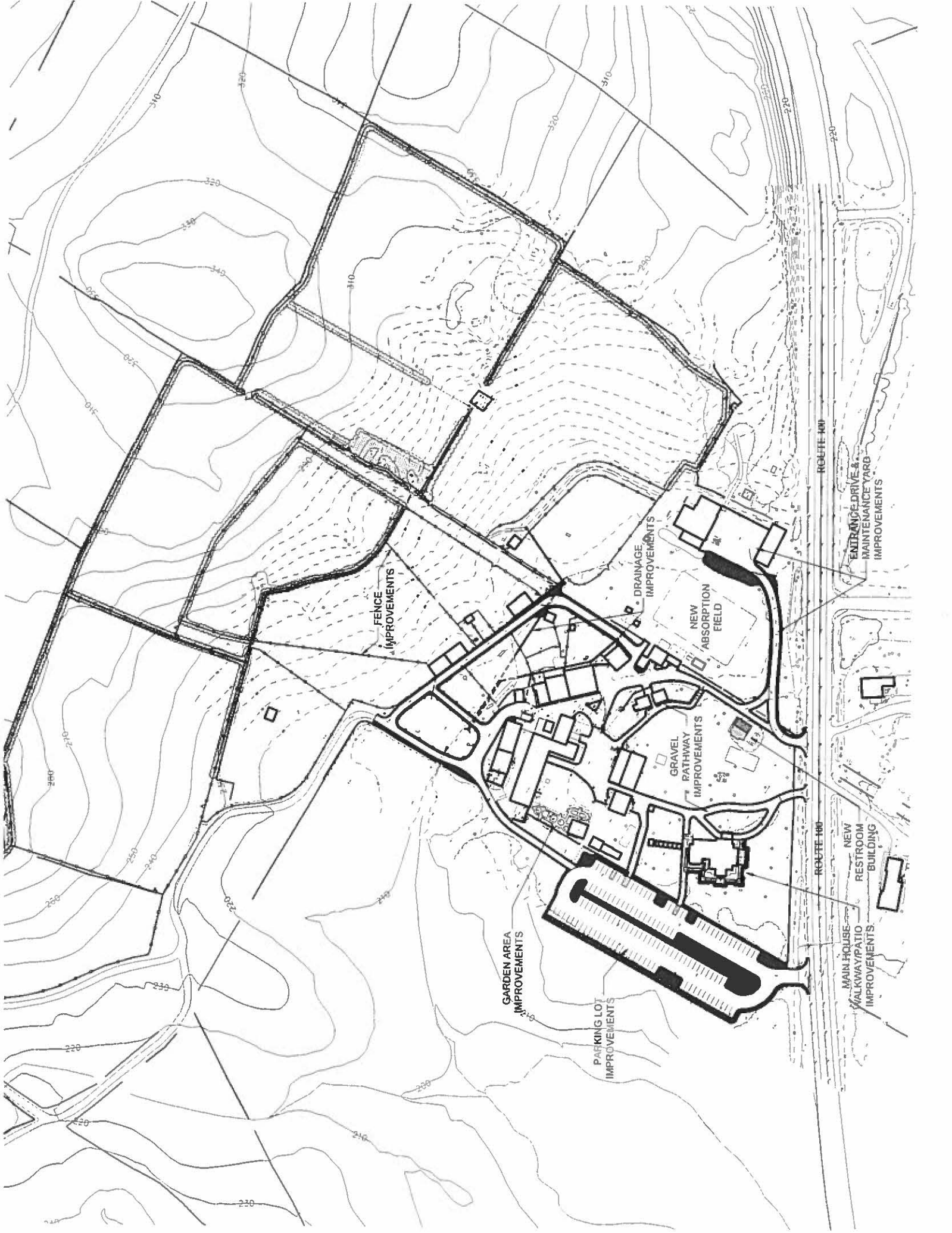

FENCE IMPROVEMENTS

DRAINAGE IMPROVEMENTS

NEW ABSORPTION FIELD

GRAVEL PATHWAY IMPROVEMENTS

GARDEN AREA IMPROVEMENTS

PARKING LOT IMPROVEMENTS

NEW HOUSE RESTROOM BUILDING IMPROVEMENTS

ENTRANCE DRIVE & MAINTENANCE YARD IMPROVEMENTS

ROUTE 141

ROUTE 140

Full Environmental Assessment Form
Part 2 - Identification of Potential Project Impacts

Agency Use Only [If applicable]
 Project : Muscoot Site/Infrastructure Improvements
 Date : June 2022

Part 2 is to be completed by the lead agency. Part 2 is designed to help the lead agency inventory all potential resources that could be affected by a proposed project or action. We recognize that the lead agency's reviewer(s) will not necessarily be environmental professionals. So, the questions are designed to walk a reviewer through the assessment process by providing a series of questions that can be answered using the information found in Part 1. To further assist the lead agency in completing Part 2, the form identifies the most relevant questions in Part 1 that will provide the information needed to answer the Part 2 question. When Part 2 is completed, the lead agency will have identified the relevant environmental areas that may be impacted by the proposed activity.

If the lead agency is a state agency and the action is in any Coastal Area, complete the Coastal Assessment Form before proceeding with this assessment.

Tips for completing Part 2:

- Review all of the information provided in Part 1.
- Review any application, maps, supporting materials and the Full EAF Workbook.
- Answer each of the 18 questions in Part 2.
- If you answer "Yes" to a numbered question, please complete all the questions that follow in that section.
- If you answer "No" to a numbered question, move on to the next numbered question.
- Check appropriate column to indicate the anticipated size of the impact.
- Proposed projects that would exceed a numeric threshold contained in a question should result in the reviewing agency checking the box "Moderate to large impact may occur."
- The reviewer is not expected to be an expert in environmental analysis.
- If you are not sure or undecided about the size of an impact, it may help to review the sub-questions for the general question and consult the workbook.
- When answering a question consider all components of the proposed activity, that is, the "whole action".
- Consider the possibility for long-term and cumulative impacts as well as direct impacts.
- Answer the question in a reasonable manner considering the scale and context of the project.

1. Impact on Land Proposed action may involve construction on, or physical alteration of, the land surface of the proposed site. (See Part 1. D.1) <i>If "Yes", answer questions a - j. If "No", move on to Section 2.</i>			
		<input type="checkbox"/> NO	<input checked="" type="checkbox"/> YES
	Relevant Part I Question(s)	No, or small impact may occur	Moderate to large impact may occur
a. The proposed action may involve construction on land where depth to water table is less than 3 feet.	E2d	<input checked="" type="checkbox"/>	<input type="checkbox"/>
b. The proposed action may involve construction on slopes of 15% or greater.	E2f	<input checked="" type="checkbox"/>	<input type="checkbox"/>
c. The proposed action may involve construction on land where bedrock is exposed, or generally within 5 feet of existing ground surface.	E2a	<input checked="" type="checkbox"/>	<input type="checkbox"/>
d. The proposed action may involve the excavation and removal of more than 1,000 tons of natural material.	D2a	<input type="checkbox"/>	<input checked="" type="checkbox"/>
e. The proposed action may involve construction that continues for more than one year or in multiple phases.	D1e	<input checked="" type="checkbox"/>	<input type="checkbox"/>
f. The proposed action may result in increased erosion, whether from physical disturbance or vegetation removal (including from treatment by herbicides).	D2e, D2q	<input checked="" type="checkbox"/>	<input type="checkbox"/>
g. The proposed action is, or may be, located within a Coastal Erosion hazard area.	B1i	<input checked="" type="checkbox"/>	<input type="checkbox"/>
h. Other impacts: _____		<input type="checkbox"/>	<input type="checkbox"/>

2. Impact on Geological Features

The proposed action may result in the modification or destruction of, or inhibit access to, any unique or unusual land forms on the site (e.g., cliffs, dunes, minerals, fossils, caves). (See Part 1. E.2.g)

NO

YES

If "Yes", answer questions a - c. If "No", move on to Section 3.

	Relevant Part I Question(s)	No, or small impact may occur	Moderate to large impact may occur
a. Identify the specific land form(s) attached: _____	E2g	<input type="checkbox"/>	<input type="checkbox"/>
b. The proposed action may affect or is adjacent to a geological feature listed as a registered National Natural Landmark. Specific feature: _____	E3c	<input type="checkbox"/>	<input type="checkbox"/>
c. Other impacts: _____		<input type="checkbox"/>	<input type="checkbox"/>

3. Impacts on Surface Water

The proposed action may affect one or more wetlands or other surface water bodies (e.g., streams, rivers, ponds or lakes). (See Part 1. D.2, E.2.h)

NO

YES

If "Yes", answer questions a - l. If "No", move on to Section 4.

	Relevant Part I Question(s)	No, or small impact may occur	Moderate to large impact may occur
a. The proposed action may create a new water body.	D2b, D1h	<input checked="" type="checkbox"/>	<input type="checkbox"/>
b. The proposed action may result in an increase or decrease of over 10% or more than a 10 acre increase or decrease in the surface area of any body of water.	D2b	<input checked="" type="checkbox"/>	<input type="checkbox"/>
c. The proposed action may involve dredging more than 100 cubic yards of material from a wetland or water body.	D2a	<input checked="" type="checkbox"/>	<input type="checkbox"/>
d. The proposed action may involve construction within or adjoining a freshwater or tidal wetland, or in the bed or banks of any other water body.	E2h	<input checked="" type="checkbox"/>	<input type="checkbox"/>
e. The proposed action may create turbidity in a waterbody, either from upland erosion, runoff or by disturbing bottom sediments.	D2a, D2h	<input checked="" type="checkbox"/>	<input type="checkbox"/>
f. The proposed action may include construction of one or more intake(s) for withdrawal of water from surface water.	D2c	<input checked="" type="checkbox"/>	<input type="checkbox"/>
g. The proposed action may include construction of one or more outfall(s) for discharge of wastewater to surface water(s).	D2d	<input checked="" type="checkbox"/>	<input type="checkbox"/>
h. The proposed action may cause soil erosion, or otherwise create a source of stormwater discharge that may lead to siltation or other degradation of receiving water bodies.	D2e	<input checked="" type="checkbox"/>	<input type="checkbox"/>
i. The proposed action may affect the water quality of any water bodies within or downstream of the site of the proposed action.	E2h	<input checked="" type="checkbox"/>	<input type="checkbox"/>
j. The proposed action may involve the application of pesticides or herbicides in or around any water body.	D2q, E2h	<input checked="" type="checkbox"/>	<input type="checkbox"/>
k. The proposed action may require the construction of new, or expansion of existing, wastewater treatment facilities.	D1a, D2d	<input type="checkbox"/>	<input checked="" type="checkbox"/>

1. Other impacts: _____ _____		<input type="checkbox"/>	<input type="checkbox"/>
----------------------------------	--	--------------------------	--------------------------

4. Impact on groundwater The proposed action may result in new or additional use of ground water, or may have the potential to introduce contaminants to ground water or an aquifer. (See Part 1. D.2.a, D.2.c, D.2.d, D.2.p, D.2.q, D.2.t) <i>If "Yes", answer questions a - h. If "No", move on to Section 5.</i>			
		<input checked="" type="checkbox"/> NO	<input type="checkbox"/> YES
	Relevant Part I Question(s)	No, or small impact may occur	Moderate to large impact may occur
a. The proposed action may require new water supply wells, or create additional demand on supplies from existing water supply wells.	D2c	<input type="checkbox"/>	<input type="checkbox"/>
b. Water supply demand from the proposed action may exceed safe and sustainable withdrawal capacity rate of the local supply or aquifer. Cite Source: _____	D2c	<input type="checkbox"/>	<input type="checkbox"/>
c. The proposed action may allow or result in residential uses in areas without water and sewer services.	D1a, D2c	<input type="checkbox"/>	<input type="checkbox"/>
d. The proposed action may include or require wastewater discharged to groundwater.	D2d, E2l	<input type="checkbox"/>	<input type="checkbox"/>
e. The proposed action may result in the construction of water supply wells in locations where groundwater is, or is suspected to be, contaminated.	D2c, E1f, E1g, E1h	<input type="checkbox"/>	<input type="checkbox"/>
f. The proposed action may require the bulk storage of petroleum or chemical products over ground water or an aquifer.	D2p, E2l	<input type="checkbox"/>	<input type="checkbox"/>
g. The proposed action may involve the commercial application of pesticides within 100 feet of potable drinking water or irrigation sources.	E2h, D2q, E2l, D2c	<input type="checkbox"/>	<input type="checkbox"/>
h. Other impacts: _____ _____		<input type="checkbox"/>	<input type="checkbox"/>

5. Impact on Flooding The proposed action may result in development on lands subject to flooding. (See Part 1. E.2) <i>If "Yes", answer questions a - g. If "No", move on to Section 6.</i>			
		<input checked="" type="checkbox"/> NO	<input type="checkbox"/> YES
	Relevant Part I Question(s)	No, or small impact may occur	Moderate to large impact may occur
a. The proposed action may result in development in a designated floodway.	E2i	<input type="checkbox"/>	<input type="checkbox"/>
b. The proposed action may result in development within a 100 year floodplain.	E2j	<input type="checkbox"/>	<input type="checkbox"/>
c. The proposed action may result in development within a 500 year floodplain.	E2k	<input type="checkbox"/>	<input type="checkbox"/>
d. The proposed action may result in, or require, modification of existing drainage patterns.	D2b, D2e	<input type="checkbox"/>	<input type="checkbox"/>
e. The proposed action may change flood water flows that contribute to flooding.	D2b, E2i, E2j, E2k	<input type="checkbox"/>	<input type="checkbox"/>
f. If there is a dam located on the site of the proposed action, is the dam in need of repair, or upgrade?	E1e	<input type="checkbox"/>	<input type="checkbox"/>

g. Other impacts: _____ _____		<input type="checkbox"/>	<input type="checkbox"/>
----------------------------------	--	--------------------------	--------------------------

6. Impacts on Air			
The proposed action may include a state regulated air emission source. (See Part 1. D.2.f., D.2.h, D.2.g) <i>If "Yes", answer questions a - f. If "No", move on to Section 7.</i>		<input checked="" type="checkbox"/> NO	<input type="checkbox"/> YES
	Relevant Part I Question(s)	No, or small impact may occur	Moderate to large impact may occur
a. If the proposed action requires federal or state air emission permits, the action may also emit one or more greenhouse gases at or above the following levels: i. More than 1000 tons/year of carbon dioxide (CO ₂) ii. More than 3.5 tons/year of nitrous oxide (N ₂ O) iii. More than 1000 tons/year of carbon equivalent of perfluorocarbons (PFCs) iv. More than .045 tons/year of sulfur hexafluoride (SF ₆) v. More than 1000 tons/year of carbon dioxide equivalent of hydrochloroflourocarbons (HFCs) emissions vi. 43 tons/year or more of methane	D2g D2g D2g D2g D2g D2h	<input type="checkbox"/> <input type="checkbox"/> <input type="checkbox"/> <input type="checkbox"/> <input type="checkbox"/> <input type="checkbox"/>	<input type="checkbox"/> <input type="checkbox"/> <input type="checkbox"/> <input type="checkbox"/> <input type="checkbox"/> <input type="checkbox"/>
b. The proposed action may generate 10 tons/year or more of any one designated hazardous air pollutant, or 25 tons/year or more of any combination of such hazardous air pollutants.	D2g	<input type="checkbox"/>	<input type="checkbox"/>
c. The proposed action may require a state air registration, or may produce an emissions rate of total contaminants that may exceed 5 lbs. per hour, or may include a heat source capable of producing more than 10 million BTU's per hour.	D2f, D2g	<input type="checkbox"/>	<input type="checkbox"/>
d. The proposed action may reach 50% of any of the thresholds in "a" through "c", above.	D2g	<input type="checkbox"/>	<input type="checkbox"/>
e. The proposed action may result in the combustion or thermal treatment of more than 1 ton of refuse per hour.	D2s	<input type="checkbox"/>	<input type="checkbox"/>
f. Other impacts: _____ _____		<input type="checkbox"/>	<input type="checkbox"/>

7. Impact on Plants and Animals			
The proposed action may result in a loss of flora or fauna. (See Part 1. E.2. m.-q.) <i>If "Yes", answer questions a - j. If "No", move on to Section 8.</i>		<input type="checkbox"/> NO	<input checked="" type="checkbox"/> YES
	Relevant Part I Question(s)	No, or small impact may occur	Moderate to large impact may occur
a. The proposed action may cause reduction in population or loss of individuals of any threatened or endangered species, as listed by New York State or the Federal government, that use the site, or are found on, over, or near the site.	E2o	<input checked="" type="checkbox"/>	<input type="checkbox"/>
b. The proposed action may result in a reduction or degradation of any habitat used by any rare, threatened or endangered species, as listed by New York State or the federal government.	E2o	<input checked="" type="checkbox"/>	<input type="checkbox"/>
c. The proposed action may cause reduction in population, or loss of individuals, of any species of special concern or conservation need, as listed by New York State or the Federal government, that use the site, or are found on, over, or near the site.	E2p	<input checked="" type="checkbox"/>	<input type="checkbox"/>
d. The proposed action may result in a reduction or degradation of any habitat used by any species of special concern and conservation need, as listed by New York State or the Federal government.	E2p	<input checked="" type="checkbox"/>	<input type="checkbox"/>

e. The proposed action may diminish the capacity of a registered National Natural Landmark to support the biological community it was established to protect.	E3c	<input checked="" type="checkbox"/>	<input type="checkbox"/>
f. The proposed action may result in the removal of, or ground disturbance in, any portion of a designated significant natural community. Source: _____	E2n	<input checked="" type="checkbox"/>	<input type="checkbox"/>
g. The proposed action may substantially interfere with nesting/breeding, foraging, or over-wintering habitat for the predominant species that occupy or use the project site.	E2m	<input checked="" type="checkbox"/>	<input type="checkbox"/>
h. The proposed action requires the conversion of more than 10 acres of forest, grassland or any other regionally or locally important habitat. Habitat type & information source: _____	E1b	<input checked="" type="checkbox"/>	<input type="checkbox"/>
i. Proposed action (commercial, industrial or recreational projects, only) involves use of herbicides or pesticides.	D2q	<input checked="" type="checkbox"/>	<input type="checkbox"/>
j. Other impacts: _____		<input type="checkbox"/>	<input type="checkbox"/>

8. Impact on Agricultural Resources			
The proposed action may impact agricultural resources. (See Part 1. E.3.a. and b.)		<input type="checkbox"/> NO	<input checked="" type="checkbox"/> YES
<i>If "Yes", answer questions a - h. If "No", move on to Section 9.</i>			
	Relevant Part I Question(s)	No, or small impact may occur	Moderate to large impact may occur
a. The proposed action may impact soil classified within soil group 1 through 4 of the NYS Land Classification System.	E2c, E3b	<input type="checkbox"/>	<input checked="" type="checkbox"/>
b. The proposed action may sever, cross or otherwise limit access to agricultural land (includes cropland, hayfields, pasture, vineyard, orchard, etc).	E1a, E1b	<input checked="" type="checkbox"/>	<input type="checkbox"/>
c. The proposed action may result in the excavation or compaction of the soil profile of active agricultural land.	E3b	<input type="checkbox"/>	<input checked="" type="checkbox"/>
d. The proposed action may irreversibly convert agricultural land to non-agricultural uses, either more than 2.5 acres if located in an Agricultural District, or more than 10 acres if not within an Agricultural District.	E1b, E3a	<input checked="" type="checkbox"/>	<input type="checkbox"/>
e. The proposed action may disrupt or prevent installation of an agricultural land management system.	E1a, E1b	<input checked="" type="checkbox"/>	<input type="checkbox"/>
f. The proposed action may result, directly or indirectly, in increased development potential or pressure on farmland.	C2c, C3, D2c, D2d	<input checked="" type="checkbox"/>	<input type="checkbox"/>
g. The proposed project is not consistent with the adopted municipal Farmland Protection Plan.	C2c	<input checked="" type="checkbox"/>	<input type="checkbox"/>
h. Other impacts: _____		<input type="checkbox"/>	<input type="checkbox"/>

9. Impact on Aesthetic Resources The land use of the proposed action are obviously different from, or are in sharp contrast to, current land use patterns between the proposed project and a scenic or aesthetic resource. (Part 1. E.1.a, E.1.b, E.3.h.) <i>If "Yes", answer questions a - g. If "No", go to Section 10.</i>			
		<input checked="" type="checkbox"/> NO	<input type="checkbox"/> YES
	Relevant Part I Question(s)	No, or small impact may occur	Moderate to large impact may occur
a. Proposed action may be visible from any officially designated federal, state, or local scenic or aesthetic resource.	E3h	<input type="checkbox"/>	<input type="checkbox"/>
b. The proposed action may result in the obstruction, elimination or significant screening of one or more officially designated scenic views.	E3h, C2b	<input type="checkbox"/>	<input type="checkbox"/>
c. The proposed action may be visible from publicly accessible vantage points: i. Seasonally (e.g., screened by summer foliage, but visible during other seasons) ii. Year round	E3h	<input type="checkbox"/> <input type="checkbox"/>	<input type="checkbox"/> <input type="checkbox"/>
d. The situation or activity in which viewers are engaged while viewing the proposed action is: i. Routine travel by residents, including travel to and from work ii. Recreational or tourism based activities	E3h E2q, E1c	<input type="checkbox"/> <input type="checkbox"/>	<input type="checkbox"/> <input type="checkbox"/>
e. The proposed action may cause a diminishment of the public enjoyment and appreciation of the designated aesthetic resource.	E3h	<input type="checkbox"/>	<input type="checkbox"/>
f. There are similar projects visible within the following distance of the proposed project: 0-1/2 mile 1/2 -3 mile 3-5 mile 5+ mile	D1a, E1a, D1f, D1g	<input type="checkbox"/>	<input type="checkbox"/>
g. Other impacts: _____ _____		<input type="checkbox"/>	<input type="checkbox"/>

10. Impact on Historic and Archeological Resources The proposed action may occur in or adjacent to a historic or archaeological resource. (Part 1. E.3.e, f. and g.) <i>If "Yes", answer questions a - e. If "No", go to Section 11.</i>			
		<input type="checkbox"/> NO	<input checked="" type="checkbox"/> YES
	Relevant Part I Question(s)	No, or small impact may occur	Moderate to large impact may occur
a. The proposed action may occur wholly or partially within, or substantially contiguous to, any buildings, archaeological site or district which is listed on the National or State Register of Historical Places, or that has been determined by the Commissioner of the NYS Office of Parks, Recreation and Historic Preservation to be eligible for listing on the State Register of Historic Places.	E3e	<input checked="" type="checkbox"/>	<input type="checkbox"/>
b. The proposed action may occur wholly or partially within, or substantially contiguous to, an area designated as sensitive for archaeological sites on the NY State Historic Preservation Office (SHPO) archaeological site inventory.	E3f	<input checked="" type="checkbox"/>	<input type="checkbox"/>
c. The proposed action may occur wholly or partially within, or substantially contiguous to, an archaeological site not included on the NY SHPO inventory. Source: _____	E3g	<input checked="" type="checkbox"/>	<input type="checkbox"/>

d. Other impacts: _____ _____		<input type="checkbox"/>	<input type="checkbox"/>
e. If any of the above (a-d) are answered "Moderate to large impact may occur", continue with the following questions to help support conclusions in Part 3:			
i. The proposed action may result in the destruction or alteration of all or part of the site or property.	E3e, E3g, E3f	<input type="checkbox"/>	<input type="checkbox"/>
ii. The proposed action may result in the alteration of the property's setting or integrity.	E3e, E3f, E3g, E1a, E1b	<input type="checkbox"/>	<input type="checkbox"/>
iii. The proposed action may result in the introduction of visual elements which are out of character with the site or property, or may alter its setting.	E3e, E3f, E3g, E3h, C2, C3	<input type="checkbox"/>	<input type="checkbox"/>

11. Impact on Open Space and Recreation			
The proposed action may result in a loss of recreational opportunities or a reduction of an open space resource as designated in any adopted municipal open space plan. (See Part 1. C.2.c, E.1.c., E.2.q.) <i>If "Yes", answer questions a - e. If "No", go to Section 12.</i>		<input checked="" type="checkbox"/> NO	<input type="checkbox"/> YES
	Relevant Part I Question(s)	No, or small impact may occur	Moderate to large impact may occur
a. The proposed action may result in an impairment of natural functions, or "ecosystem services", provided by an undeveloped area, including but not limited to stormwater storage, nutrient cycling, wildlife habitat.	D2e, E1b, E2h, E2m, E2o, E2n, E2p	<input type="checkbox"/>	<input type="checkbox"/>
b. The proposed action may result in the loss of a current or future recreational resource.	C2a, E1c, C2c, E2q	<input type="checkbox"/>	<input type="checkbox"/>
c. The proposed action may eliminate open space or recreational resource in an area with few such resources.	C2a, C2c, E1c, E2q	<input type="checkbox"/>	<input type="checkbox"/>
d. The proposed action may result in loss of an area now used informally by the community as an open space resource.	C2c, E1c	<input type="checkbox"/>	<input type="checkbox"/>
e. Other impacts: _____ _____		<input type="checkbox"/>	<input type="checkbox"/>

12. Impact on Critical Environmental Areas			
The proposed action may be located within or adjacent to a critical environmental area (CEA). (See Part 1. E.3.d) <i>If "Yes", answer questions a - c. If "No", go to Section 13.</i>		<input type="checkbox"/> NO	<input checked="" type="checkbox"/> YES
	Relevant Part I Question(s)	No, or small impact may occur	Moderate to large impact may occur
a. The proposed action may result in a reduction in the quantity of the resource or characteristic which was the basis for designation of the CEA.	E3d	<input checked="" type="checkbox"/>	<input type="checkbox"/>
b. The proposed action may result in a reduction in the quality of the resource or characteristic which was the basis for designation of the CEA.	E3d	<input checked="" type="checkbox"/>	<input type="checkbox"/>
c. Other impacts: _____ _____		<input type="checkbox"/>	<input type="checkbox"/>

13. Impact on Transportation
 The proposed action may result in a change to existing transportation systems. NO YES
 (See Part 1. D.2.j)
If "Yes", answer questions a - f. If "No", go to Section 14.

	Relevant Part I Question(s)	No, or small impact may occur	Moderate to large impact may occur
a. Projected traffic increase may exceed capacity of existing road network.	D2j	<input type="checkbox"/>	<input type="checkbox"/>
b. The proposed action may result in the construction of paved parking area for 500 or more vehicles.	D2j	<input type="checkbox"/>	<input type="checkbox"/>
c. The proposed action will degrade existing transit access.	D2j	<input type="checkbox"/>	<input type="checkbox"/>
d. The proposed action will degrade existing pedestrian or bicycle accommodations.	D2j	<input type="checkbox"/>	<input type="checkbox"/>
e. The proposed action may alter the present pattern of movement of people or goods.	D2j	<input type="checkbox"/>	<input type="checkbox"/>
f. Other impacts: _____ _____		<input type="checkbox"/>	<input type="checkbox"/>

14. Impact on Energy
 The proposed action may cause an increase in the use of any form of energy. NO YES
 (See Part 1. D.2.k)
If "Yes", answer questions a - e. If "No", go to Section 15.

	Relevant Part I Question(s)	No, or small impact may occur	Moderate to large impact may occur
a. The proposed action will require a new, or an upgrade to an existing, substation.	D2k	<input type="checkbox"/>	<input type="checkbox"/>
b. The proposed action will require the creation or extension of an energy transmission or supply system to serve more than 50 single or two-family residences or to serve a commercial or industrial use.	D1f, D1q, D2k	<input type="checkbox"/>	<input type="checkbox"/>
c. The proposed action may utilize more than 2,500 MWhrs per year of electricity.	D2k	<input type="checkbox"/>	<input type="checkbox"/>
d. The proposed action may involve heating and/or cooling of more than 100,000 square feet of building area when completed.	D1g	<input type="checkbox"/>	<input type="checkbox"/>
e. Other Impacts: _____ _____			

15. Impact on Noise, Odor, and Light
 The proposed action may result in an increase in noise, odors, or outdoor lighting. NO YES
 (See Part 1. D.2.m., n., and o.)
If "Yes", answer questions a - f. If "No", go to Section 16.

	Relevant Part I Question(s)	No, or small impact may occur	Moderate to large impact may occur
a. The proposed action may produce sound above noise levels established by local regulation.	D2m	<input type="checkbox"/>	<input type="checkbox"/>
b. The proposed action may result in blasting within 1,500 feet of any residence, hospital, school, licensed day care center, or nursing home.	D2m, E1d	<input type="checkbox"/>	<input type="checkbox"/>
c. The proposed action may result in routine odors for more than one hour per day.	D2o	<input type="checkbox"/>	<input type="checkbox"/>

d. The proposed action may result in light shining onto adjoining properties.	D2n	<input type="checkbox"/>	<input type="checkbox"/>
e. The proposed action may result in lighting creating sky-glow brighter than existing area conditions.	D2n, E1a	<input type="checkbox"/>	<input type="checkbox"/>
f. Other impacts: _____ _____		<input type="checkbox"/>	<input type="checkbox"/>

16. Impact on Human Health

The proposed action may have an impact on human health from exposure to new or existing sources of contaminants. (See Part 1.D.2.q., E.1. d. f. g. and h.)

NO

YES

If "Yes", answer questions a - m. If "No", go to Section 17.

	Relevant Part I Question(s)	No, or small impact may occur	Moderate to large impact may occur
a. The proposed action is located within 1500 feet of a school, hospital, licensed day care center, group home, nursing home or retirement community.	E1d	<input type="checkbox"/>	<input type="checkbox"/>
b. The site of the proposed action is currently undergoing remediation.	E1g, E1h	<input type="checkbox"/>	<input type="checkbox"/>
c. There is a completed emergency spill remediation, or a completed environmental site remediation on, or adjacent to, the site of the proposed action.	E1g, E1h	<input type="checkbox"/>	<input type="checkbox"/>
d. The site of the action is subject to an institutional control limiting the use of the property (e.g., easement or deed restriction).	E1g, E1h	<input type="checkbox"/>	<input type="checkbox"/>
e. The proposed action may affect institutional control measures that were put in place to ensure that the site remains protective of the environment and human health.	E1g, E1h	<input type="checkbox"/>	<input type="checkbox"/>
f. The proposed action has adequate control measures in place to ensure that future generation, treatment and/or disposal of hazardous wastes will be protective of the environment and human health.	D2t	<input type="checkbox"/>	<input type="checkbox"/>
g. The proposed action involves construction or modification of a solid waste management facility.	D2q, E1f	<input type="checkbox"/>	<input type="checkbox"/>
h. The proposed action may result in the unearthing of solid or hazardous waste.	D2q, E1f	<input type="checkbox"/>	<input type="checkbox"/>
i. The proposed action may result in an increase in the rate of disposal, or processing, of solid waste.	D2r, D2s	<input type="checkbox"/>	<input type="checkbox"/>
j. The proposed action may result in excavation or other disturbance within 2000 feet of a site used for the disposal of solid or hazardous waste.	E1f, E1g E1h	<input type="checkbox"/>	<input type="checkbox"/>
k. The proposed action may result in the migration of explosive gases from a landfill site to adjacent off site structures.	E1f, E1g	<input type="checkbox"/>	<input type="checkbox"/>
l. The proposed action may result in the release of contaminated leachate from the project site.	D2s, E1f, D2r	<input type="checkbox"/>	<input type="checkbox"/>
m. Other impacts: _____ _____			

17. Consistency with Community Plans The proposed action is not consistent with adopted land use plans. (See Part 1. C.1, C.2. and C.3.) <i>If "Yes", answer questions a - h. If "No", go to Section 18.</i>			
		<input checked="" type="checkbox"/> NO	<input type="checkbox"/> YES
	Relevant Part I Question(s)	No, or small impact may occur	Moderate to large impact may occur
a. The proposed action's land use components may be different from, or in sharp contrast to, current surrounding land use pattern(s).	C2, C3, D1a E1a, E1b	<input type="checkbox"/>	<input type="checkbox"/>
b. The proposed action will cause the permanent population of the city, town or village in which the project is located to grow by more than 5%.	C2	<input type="checkbox"/>	<input type="checkbox"/>
c. The proposed action is inconsistent with local land use plans or zoning regulations.	C2, C2, C3	<input type="checkbox"/>	<input type="checkbox"/>
d. The proposed action is inconsistent with any County plans, or other regional land use plans.	C2, C2	<input type="checkbox"/>	<input type="checkbox"/>
e. The proposed action may cause a change in the density of development that is not supported by existing infrastructure or is distant from existing infrastructure.	C3, D1c, D1d, D1f, D1d, E1b	<input type="checkbox"/>	<input type="checkbox"/>
f. The proposed action is located in an area characterized by low density development that will require new or expanded public infrastructure.	C4, D2c, D2d D2j	<input type="checkbox"/>	<input type="checkbox"/>
g. The proposed action may induce secondary development impacts (e.g., residential or commercial development not included in the proposed action)	C2a	<input type="checkbox"/>	<input type="checkbox"/>
h. Other: _____ _____		<input type="checkbox"/>	<input type="checkbox"/>

18. Consistency with Community Character The proposed project is inconsistent with the existing community character. (See Part 1. C.2, C.3, D.2, E.3) <i>If "Yes", answer questions a - g. If "No", proceed to Part 3.</i>			
		<input checked="" type="checkbox"/> NO	<input type="checkbox"/> YES
	Relevant Part I Question(s)	No, or small impact may occur	Moderate to large impact may occur
a. The proposed action may replace or eliminate existing facilities, structures, or areas of historic importance to the community.	E3e, E3f, E3g	<input type="checkbox"/>	<input type="checkbox"/>
b. The proposed action may create a demand for additional community services (e.g. schools, police and fire)	C4	<input type="checkbox"/>	<input type="checkbox"/>
c. The proposed action may displace affordable or low-income housing in an area where there is a shortage of such housing.	C2, C3, D1f D1g, E1a	<input type="checkbox"/>	<input type="checkbox"/>
d. The proposed action may interfere with the use or enjoyment of officially recognized or designated public resources.	C2, E3	<input type="checkbox"/>	<input type="checkbox"/>
e. The proposed action is inconsistent with the predominant architectural scale and character.	C2, C3	<input type="checkbox"/>	<input type="checkbox"/>
f. Proposed action is inconsistent with the character of the existing natural landscape.	C2, C3 E1a, E1b E2g, E2h	<input type="checkbox"/>	<input type="checkbox"/>
g. Other impacts: _____ _____		<input type="checkbox"/>	<input type="checkbox"/>

Full Environmental Assessment Form
Part 3 - Evaluation of the Magnitude and Importance of Project Impacts
and
Determination of Significance

Part 3 provides the reasons in support of the determination of significance. The lead agency must complete Part 3 for every question in Part 2 where the impact has been identified as potentially moderate to large or where there is a need to explain why a particular element of the proposed action will not, or may, result in a significant adverse environmental impact.

Based on the analysis in Part 3, the lead agency must decide whether to require an environmental impact statement to further assess the proposed action or whether available information is sufficient for the lead agency to conclude that the proposed action will not have a significant adverse environmental impact. By completing the certification on the next page, the lead agency can complete its determination of significance.

Reasons Supporting This Determination:

To complete this section:

- Identify the impact based on the Part 2 responses and describe its magnitude. Magnitude considers factors such as severity, size or extent of an impact.
- Assess the importance of the impact. Importance relates to the geographic scope, duration, probability of the impact occurring, number of people affected by the impact and any additional environmental consequences if the impact were to occur.
- The assessment should take into consideration any design element or project changes.
- Repeat this process for each Part 2 question where the impact has been identified as potentially moderate to large or where there is a need to explain why a particular element of the proposed action will not, or may, result in a significant adverse environmental impact.
- Provide the reason(s) why the impact may, or will not, result in a significant adverse environmental impact
- For Conditional Negative Declarations identify the specific condition(s) imposed that will modify the proposed action so that no significant adverse environmental impacts will result.
- Attach additional sheets, as needed.

See attachment.

Determination of Significance - Type 1 and Unlisted Actions

SEQR Status: Type 1 Unlisted

Identify portions of EAF completed for this Project: Part 1 Part 2 Part 3

Upon review of the information recorded on this EAF, as noted, plus this additional support information

and considering both the magnitude and importance of each identified potential impact, it is the conclusion of the County of Westchester, acting by and through its Board of Legislators, _____ as lead agency that:

A. This project will result in no significant adverse impacts on the environment, and, therefore, an environmental impact statement need not be prepared. Accordingly, this negative declaration is issued.

B. Although this project could have a significant adverse impact on the environment, that impact will be avoided or substantially mitigated because of the following conditions which will be required by the lead agency:

There will, therefore, be no significant adverse impacts from the project as conditioned, and, therefore, this conditioned negative declaration is issued. A conditioned negative declaration may be used only for UNLISTED actions (see 6 NYCRR 617.d).

C. This Project may result in one or more significant adverse impacts on the environment, and an environmental impact statement must be prepared to further assess the impact(s) and possible mitigation and to explore alternatives to avoid or reduce those impacts. Accordingly, this positive declaration is issued.

Name of Action: Muscote Farm Site and Infrastructure Improvements

Name of Lead Agency: County of Westchester

Name of Responsible Officer in Lead Agency: Malika Vanderberg

Title of Responsible Officer: Clerk and Chief Administrative Officer of the Westchester County Board of Legislators

Signature of Responsible Officer in Lead Agency:

Date:

Signature of Preparer (if different from Responsible Officer)

DarKusge

Date:

June 23, 2022

For Further Information:

Contact Person: David S. Kvinge, Assistant Commissioner

Address: 148 Martine Avenue, Room 432, White Plains, NY 10601

Telephone Number: 914-995-4400

E-mail: dsk2@westchestergov.com

For Type 1 Actions and Conditioned Negative Declarations, a copy of this Notice is sent to:

Chief Executive Officer of the political subdivision in which the action will be principally located (e.g., Town / City / Village of)

Other involved agencies (if any)

Applicant (if any)

Environmental Notice Bulletin: <http://www.dec.ny.gov/enb/enb.html>

MUSCOOT FARM SITE AND INFRASTRUCTURE IMPROVEMENTS

EAF Part 3

Impact on Land

There will be minimal land impacts as this project is centered on the rehabilitation of existing facilities at a popular County park. The facilities are concentrated in a small portion of the 777-acre park. Improvements will serve to rectify site problems and minimize environmental impacts associated with continuing farm operations and public use.

Existing dirt/gravel pathways will be reconstructed with fresh gravel. The existing visitor parking lot will be converted from compacted soil/gravel to porous asphalt pavement. This will improve parking conditions while allowing for infiltration and reducing erosion.

The active area between the maintenance building and maintenance barn, as well as the road leading to the maintenance facility, will be replaced with asphalt. Although this will add approximately 12,000 square feet of impervious surface, this will better protect the environment from accidental spills and erosive forces that could occur with maintenance operations and heavy equipment. Only a short portion of the main house driveway, where it meets Route 100, will also be paved and will not have any significant impact.

A stormwater collection basin will be constructed by excavating a former paddock to rectify ponding and saturated soil conditions in active portions of the farm, which is situated at the bottom of a hillside. The basin will be approximately 8,800 square feet and 5 feet deep and will be planted with a wetland meadow mix. The bioretention area will be within the cleared open area on the west side of the maintenance area.

Additional excavation will be needed to install new sewage infrastructure. A new septic field will be created in the field to the west of the maintenance facility, in an area that was used to grow vegetables. It will require a disturbance of approximately 8,300 square feet, which will be re-landscaped with grass following installation. A portion of the excavated soils will be returned to the project site as backfill.

The facilities mentioned above are essentially located on the more level areas of the park property, which will not result in significant erosion during construction. The project will include both temporary and permanent measures to control erosion in accordance with the *New York State Standards and Specifications for Erosion and Sediment Control*. Temporary controls during construction will include silt fencing, check dams, stabilized construction entrances, catch basin sacks, stockpile protection, mulching and seeding as needed, and good housekeeping practices, among others.

The project area containing steep slopes and rock outcrops are essentially the pastures. The work in the pasture areas involves replacement of fencing essentially along the same lines, which will have minimal impact to both existing bedrock and steep slopes.

Impact on Surface Water

Muscot is located within the Croton Watershed, which is part of the New York City drinking water supply.

The proposed improvements will serve to protect surface water resources. The new septic system will replace smaller aging onsite septic systems, ensuring adequate treatment of sanitary wastewater generated at this popular park. The installation of porous pavement for the existing parking lot will reduce erosion while maintaining infiltration, which may be better than under the present compacted conditions. Conversely, installation of impervious pavement at the maintenance facility will better guard against potential site contamination from maintenance operations.

A Stormwater Pollution Prevention Plan (SWPPP) has been developed that includes both erosion and sediment control measures during construction, as well as post-construction stormwater management practices that meet the water quality and quantity treatment requirements in accordance with the *New York State Stormwater Management Design Manual*.

The project will implement several practices to improve stormwater management at the site. Currently, excess stormwater flows down the hill to the barns, creating muddy conditions around the active areas of the farm. A drainage ditch collects and conveys the excess stormwater through this active area, which is not conducive to farm operations. To alleviate this problem, a swale will be constructed at the base of the hill to collect stormwater flowing down the hill and a drainage collection system will be installed in the vicinity of the farm buildings to pipe the excess stormwater to a new basin that will be created at the last paddock to the west. The drainage ditches will be filled and returned to farm use. The stormwater basin will be designed as a detention facility, allowing for infiltration. Since the outlet control structure for the basin will utilize an existing pipe which currently conveys the stormwater from the drainage ditch under the roadway to the vacant land owned by New York City Department of Environmental Protection (NYCDEP), this will not result in any new impacts.

A bioretention basin will be constructed on the west side of the maintenance facility lot that will provide both water quality and quantity treatment of stormwater runoff from the new pavement. An outlet control structure on the south end of the basin will convey stormwater overflows to a subsurface pipe underneath the maintenance driveway that will discharge into a depression beside Route 100. The outfall area will be rip-rapped to prevent erosion. A stone infiltration trench with multiple small outlets will be added along the west side of the porous pavement parking lot to collect and disperse overflows from the main parking lot during heavier storms.

Impact on Plants and Animals

The 777-acre county park property contains a variety of habitats supporting a variety of wildlife. The western portion of the park has been designated as a Biodiversity Reserve. Improvements are limited to areas that have already been disturbed and are in active use at this time. The project does not affect existing natural habitats or involve a change in use that would impact wildlife.

With the exception of only a few areas, much of the park property had at one time been cleared for agricultural purposes and are currently in various stages of succession. Wildlife associated with successional forests that may cross over into the farm may include various birds, insects, and mammals. Aside from the drainage ditch through the active area of the farm, the project area does not include any waterbodies or wetlands, so there will be no impact on amphibians or other species dependent on such sites.

Impacts to plants primarily involve the removal of vegetation that have been left to grow up around the fence lines around the pastures. Just four mature trees will need to be removed to accommodate the improvements around the main facilities. Tree protection will be installed around the perimeter of the main parking lot as well as at various locations where they may be impacted during construction. A variety of native plants will be added to the bioretention basin next to the maintenance facility and a wetland meadow mix will be applied to the converted paddock.

Impact on Agricultural Resources

Muscot is a working farm and is included in the Westchester County Agricultural District. The project will support continued farm use as well as the public educational component that promotes farming.

According to the Natural Resources Conservation Service Web Soil Survey, the parking lot, new restroom and new septic field will be located on Hinckley loamy sand, 3-8 percent slopes, (HnB) which is identified as farmland of statewide importance, but is placed in Soil Group 6 by the New York Department of Agriculture and Markets. Since the parking lot improvements will be located over the existing parking area, it will not impact existing agricultural uses. The new restroom will also have minimal impact as it will be located close to the maintenance driveway on land that is disturbed, but not in agricultural use. The new septic field will be located within an area that was used to grow vegetables. Once the septic system is installed, the field will be covered with 12 inches of backfill and 6 inches of topsoil and may return to agricultural use.

The stormwater collection basin will be located within Sutton loam, 3-8 percent slopes (SuB), which is identified as prime farmland according to the Web Soil Survey and is listed in Soil Group 3 by the Department of Agriculture and Markets. This area previously served as a

paddock for livestock, but there is sufficient land available to serve in this capacity. Some of the excavated soils may be retained for use elsewhere within the farm/park. The proposed stormwater improvements will allow a small area near the active barns to return to agricultural use.

Impact on Historic and Archeological Resources

Although Muscoot Farm has been identified as eligible for listing on the New York State Register of Historic Places, this project will not have an adverse impact as it serves to protect and support this historic resource.

The property has also been identified on the New York State Historic Preservation Office (SHPO) archeological site inventory as being in an area designated as sensitive for archaeological resources. As the project will only affect existing disturbed areas, no impact on archaeological resources are anticipated.

In a letter dated April 15, 2022, the Division for Historic Preservation of the New York State Office of Parks, Recreation and Historic Preservation concluded that the project will have no impact on archaeological and/or historic resources listed in or eligible for the New York State and National Registers of Historic Places provided that the design of new bathroom building will be compatible with the existing historic buildings and the new fences will match or be similar with the existing wood fencing, which they will be.

Impact on Critical Environmental Areas

All County parks within Westchester were designated as Critical Environmental Areas by the County for the variety of benefits they provide, including recreational, educational, social, cultural and ecological benefits.

The proposed improvements will protect and advance the purposes of this CEA.